

ER9.5/5 CORES

CORES

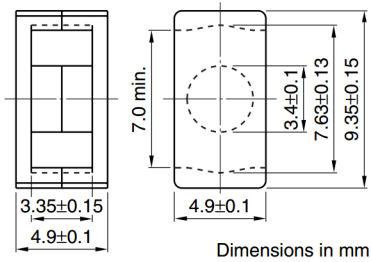

Dimensions in mm

Parameter

Core factor	C ₁	mm ⁻¹	1.67
Effective magnetic path length	ℓ _e	mm	14.2
Effective cross-sectional area	A _e	mm ²	8.47
Effective core volume	V _e	mm ³	120
Cross-sectional center pole area	A _{cp}	mm ²	9.08
Minimum cross-sectional area	A _{cp min.}	mm ²	8.55
Cross-sectional winding area of core	A _{cw}	mm ²	7.1
Weight (approx.)	g		0.6

TYPICAL CHARACTERISTICS

Part No.	AL-value(nH/N ²) [1kHz, 0.5mA, 100Ts]		Core loss (W) [at 100°C]	
	Without air gap	With air gap	100kHz 200mT	500kHz 50mT
PC44ER9.5/5-□□□*1	610 min.	63±5% 100±7%		
PC50ER9.5/5-□□□	750±25%	63±5% 100±7%		0.015
H5C3ER9.5/5-Z*2	3500 min.			

*1 Including AL-value

*2 10kHz, 10mV, 100Ts

BOBBINS

BER9.5/5-118GAFR

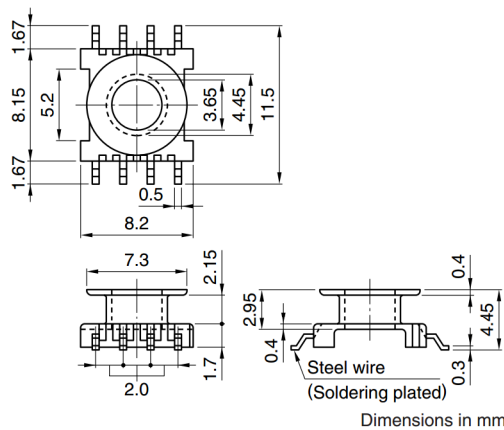

Dimensions in mm

CONNECTING PIN PATTERNS

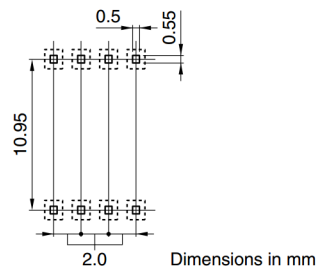

Dimensions in mm

Part No.	Material	Heat deflection temperature (°C)*1	UL standard	Available winding core section A _w (mm ²)	Average length of turns ℓ _w (mm)	Minimum thickness t(mm)*2	Weight (g)
BER9.5/5-118GAFR	FR phenol	235	94V-0	3.06	18.5	0.4	0.16

*1 With 18.6kg/cm² force

*2 Minimum thickness of bobbin

ASSEMBLY

SURFACE MOUNT TYPE

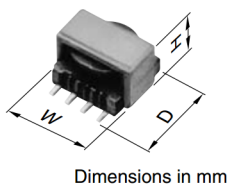

Dimensions in mm

W	9.9
D	11.7
H	5.8

ACCESSORIES

CLAMP

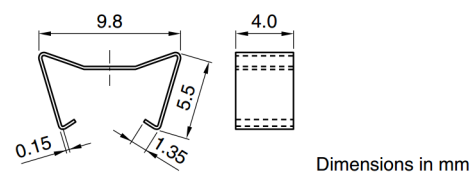

Dimensions in mm

Part No.	Material	Weight (g)
FER9.5/5-A	Stainless steel	0.1